

HISTORIC PRESERVATION COMMISSION

October 11, 2022, 5:30p.m.

**Council Auditorium
City Hall
103 North Perry Street**

HISTORIC PRESERVATION COMMISSION MEMBERS

Dr. Richard Bailey, Chair

Dr. Dallas Hanbury, Vice-Chair

Dr. Melissa Bailey

Ms. Michelle Browder

Ms. Camilla Debardelaben

Mr. Rob Hessee

Ms. Carole King

Mr. James Long

LAND USE DIVISION

Thomas M. Tyson,
Executive Secretary

*The next scheduled meeting of the Historic Preservation Commission is
November 8, 2022*

- I. Approval of Actions from the August 9, 2022
- II. Proposal for Montgomery Bus Boycott Historic Civil Rights Trail (Dr. Bailey)
 - See attached
- III. Mapco update
 - Mapco presented revised proposal to Cottage Hill September 8, 2022, at the Sanctuary, 432 S. Goldthwaite
- IV. Fall Sign Committee: Michelle Browder, Richard Bailey, Rob Hessee
 - Recommendation to award signs to:
 - 2095 South Hull Street
 - 2321 West Cloverdale Park
- V. Other business
 - First Presbyterian/Sayre Street School
 - St. Jude Apartments

Montgomery Bus Boycott Historic Civil Rights Trail A Proposal

The Montgomery Bus Boycott and the Selma to Montgomery March were two of the greatest mass movements in American history. While Montgomery has a trail to mark the historic march of 1965, the city can benefit greatly by creating similar recognition for the earlier bus boycott.

The two-part proposed Montgomery Bus Boycott Historic Civil Rights Trail will focus on the period from December 5, 1955, with the trial of seamstress Rosa L. Parks, to December 20, 1956, when **Browder v. Gayle* took effect.

The proposed trail will highlight people and places associated with the success of the bus boycott to enhance tourists' understanding and appreciation for their public utterances and their private deeds.

Embracing two geographical areas, the Montgomery Bus Boycott Historic Civil Rights Trail–West will begin at the intersection of Holt and Stone Streets and end in the 1200 block on now-Rosa L. Parks Avenue. It will also include Clinton and Columbia Streets and several blocks along then-West Jeff Davis Avenue.

The Montgomery Bus Boycott Historic Civil Rights Trail–East will commence at Jackson and Key Streets and conclude in the 900 block of South Jackson Street. It will also include High Street, Highland Avenue, and Grove, Dericote, Bolivar, Shephard, and Union Streets.

List A focuses on people and addresses for the western segment of the trail; List B does the same for the eastern segment.

List A (west)

Name

Address

Significance

1. Mt. Zion AME Zion Church	657 South Holt Street	Montgomery Improvement Association (MIA) organized
2. Lee's Funeral Home	731 South Holt Street	Enterprise of C.W. Lee
3. Rev. L. Roy Bennett	721 South Holt Street	Mt. Zion AME Zion parsonage
4. Rev. A.W. Wilson	847 West Jeff Davis	Holt Street Baptist Church parsonage
5. Lowe's Adult School	846 West Jeff Davis	Business of Jimmie Lowe
6. Clarence W. Lee	686 West Jeff Davis	*Indicted MIA board member
7. Erna Ashley Dungee	668 West Jeff Davis	MIA board member residence
8. Shaw's Bakery	815 West Jeff Davis	Atty F.D. Gray wedding purchase
9. Loveless Jr. High School	921 West Jeff Davis	T.H. Randall principal
10. C.T. Smiley	715 Bullock	715 Bullock
11. Holt Street Baptist Church	905 South Holt Street	First mass meeting site
12. Holt Street Church of Christ	941 South Holt Street	*** Atty Fred D Gray's church
13. Jimmie Lowe	849 Cleveland Avenue	Indicted MIA member
14. Rosa L. Parks	634 Columbia Street	Catalyst for change
15. Stella Brooks	633 Columbia Street	Testified in <i>Browder</i> case
16. Mose Whatley Richburg	678 Columbia Street	Indicted
17. Rev. Robert Graetz	1104 Cleveland Avenue	MIA board member
18. E.D. Nixon	647 Clinton Street	MIA board member
19. Susie McDonald	1254 Cleveland Avenue	Plaintiff in <i>Browder</i> case

Note: Cleveland Avenue is now Rosa L. Parks Avenue, and Jeff Davis Avenue was renamed Atty. Fred D. Gray Avenue in 2021.

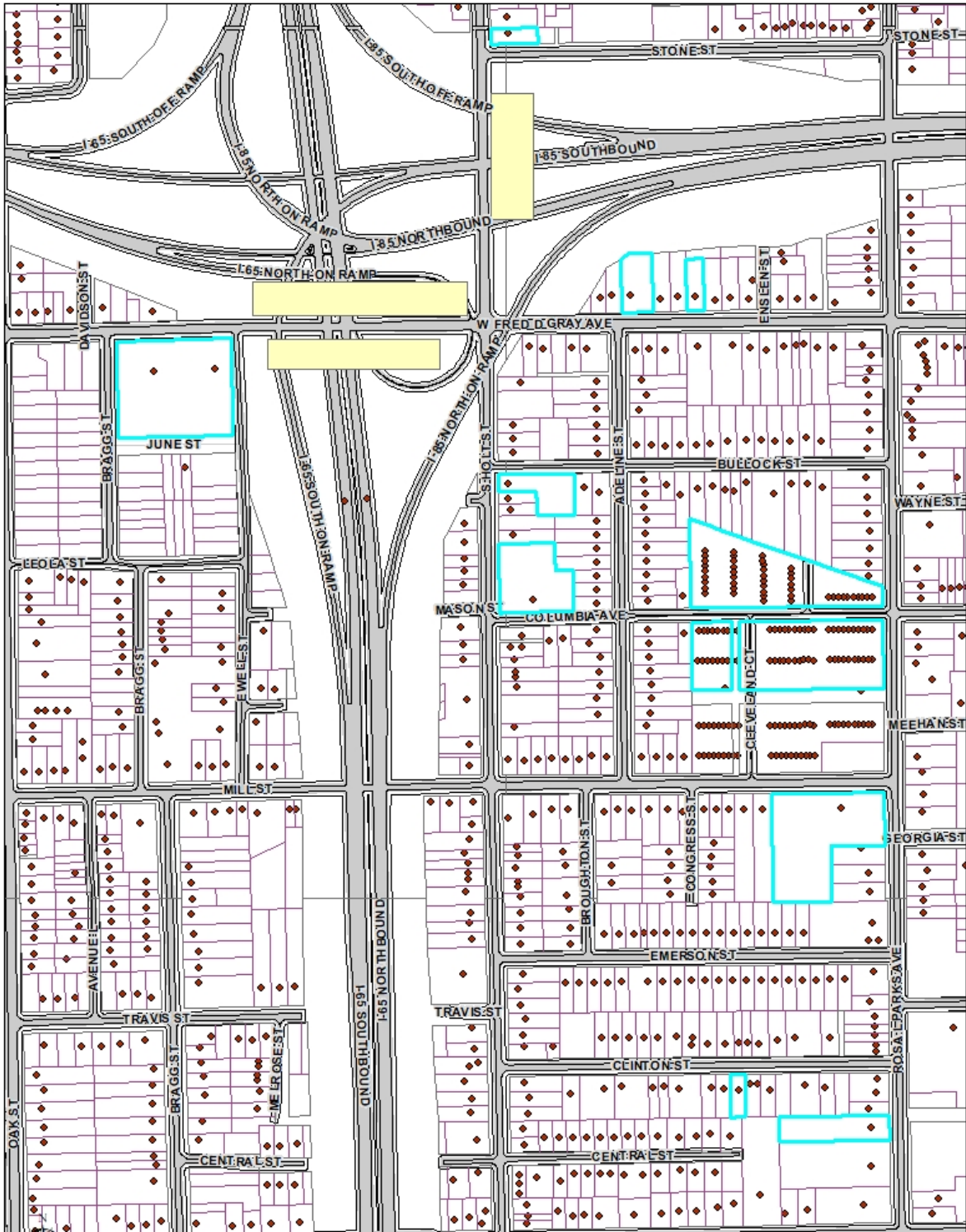

1 inch = 343 feet

List B (east)

Name

1. Reverend Martin Luther King, Jr.
2. Richard Harris
3. People Cab Company
4. Hotel Ben Moore
5. Aurelia Shines Browder
6. Rufus Lewis
7. Georgia Gilmore
8. Rev. B. D. Lambert
9. Eurette Adair
10. MIA Office (Bricklayers Hall)
11. Booker T. Washington School
12. Rev. W. F. Alford
13. Beulah Baptist Church
14. Hutchinson Missionary Baptist
15. E.H. Ligon
16. Ruth Vines
17. Brewer Building
Advertiser/Journal
18. Audrey Belle Langford
19. Att. Charles D. Langford
20. College Hill Barber Shop
21. Rev. H.H. Johnson
22. Irene Moore West
23. Rev. J.H. Cherry
24. Sadie Brooks
25. Mary Fair Burks
26. John Cannon
27. James E. Pierce
28. Jo Ann Robinson

Address

- 309 South Jackson St
 333 South Jackson St
 849 High St
 902 Highland Ave
 1012 Highland Ave
 801 Bolivar
 405-407 Dericote St
 724 High St
 442 South Union St
 534 South Union St
 607 South Union St
 623 south Union St
 629 South Union St
 860 Grove St (new location)
 863 Grove Street
 475 South Jackson St
 494a South Jackson St

 918 Grove St
 918 Grove St
 719 Shephard St
 606 South Jackson St
 724 South Jackson St
 814 South Jackson St
 Alabama State University
 Alabama State University
 Alabama State University
 Alabama State University
 Alabama State University

Significance

- MIA spokesperson
 Car pool coordinator
 ****site of bomb blast
 Center of civil rights activities
 Lead plaintiff in *Browder* case
 MIA board member
 Testified in *Browder* case
 Indicted MIA board member
 Indicted MIA board member
 MIA office
 Claudette Colvin's school
 MIA board member
 Church of Reverend Alford
 Church of Rev. H.H. Johnson
 Indicated MIA board member
 Women's Political Council
 Negro News

 Indicted
 MIA attorney
 Indicted MIA board member
 MLK received first haircut
 Indicted MIA board member
 Indicted MIA board member
 Testified in *Browder* case
 WPC member
 Helped mimeograph leaflets
 Indicted MIA board member
 Indicted MIA board member

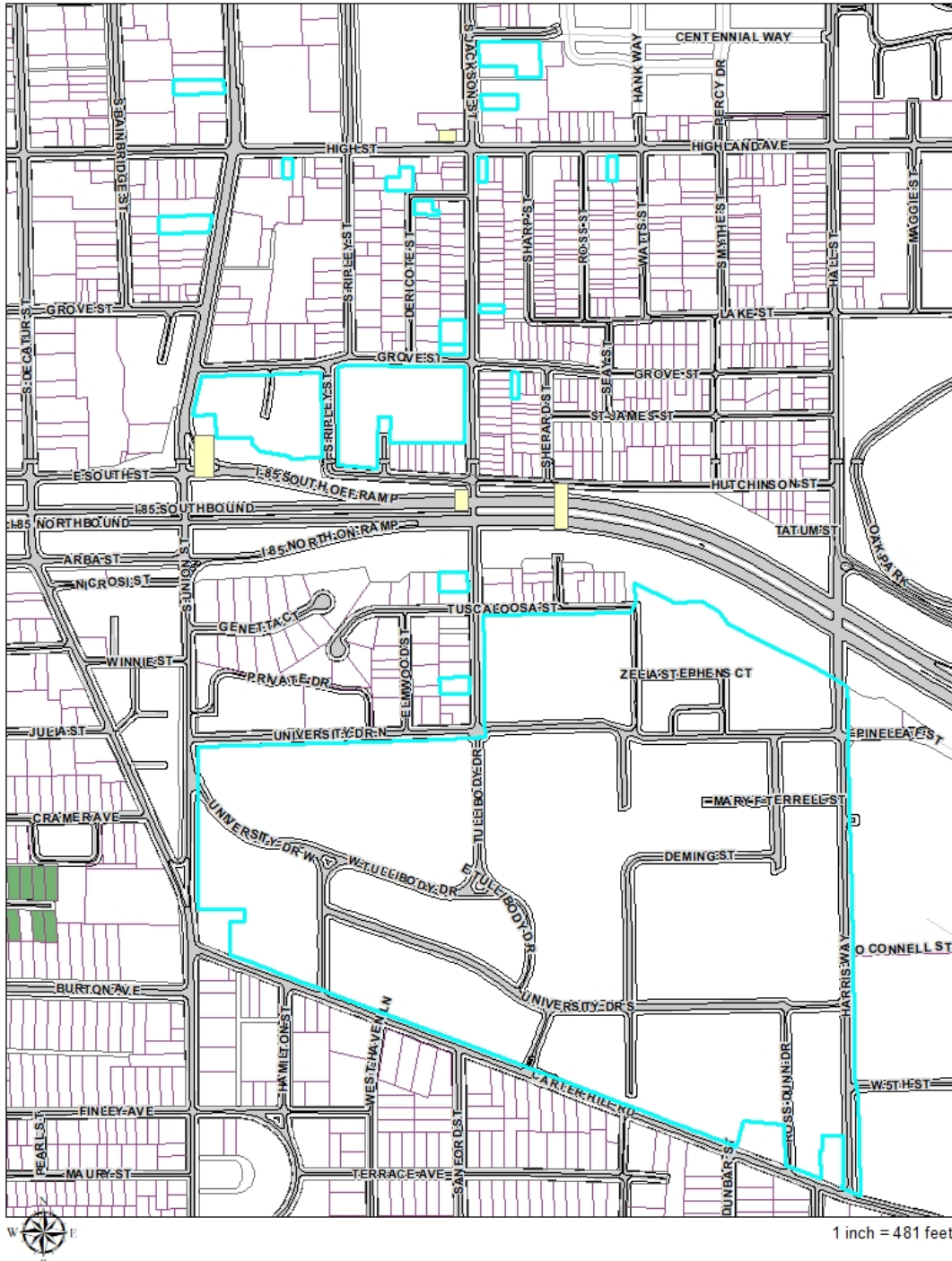

*In *Browder v. Gayle*, the United States Supreme Court ruled that certain local segregation laws violated the due process and equal protect clauses of the Fourteenth Amendment, enabling *Browder v. Gayle* to set a precedence in such matters.

**The Code of Alabama
Title 14, Section 54

Two or more persons who, without a just cause or legal excuse for so doing, enter into any combination, conspiracy, agreement, arrangement, or understanding for the purpose of hindering, delaying, or preventing any other persons, firms, corporation, or association of persons from carrying on any lawful business, shall be guilty of a misdemeanor.

***Atty. Fred D. Gray and Bernice Hill were married from the Holt Street Baptist Church on June 17, 1956 because his church was constructing a new building and was considered too small for the crowd that had filled it by three for the six o'clock wedding. K. K. Mitchell, his pastor, performed the ceremony. The reception was held at Dungee Caffey's Derby Supper Club, located at 2045 Day Street. Caffey, who lived at 667 W. Jeff Davis, posted the bond for many of those indicted.

***Eighteen African American cab companies and their 210 drivers helped to make the bus boycott a success.

****The *Montgomery Advertiser* and the *Alabama Journal* included a section for readers of news regarding the black community. In 1945 persons who wanted their stories publicized in "News of Colored People" brought their stories to the home of reporter Eliza Streety at 143 Roanoke Street. To ensure publication the following day, an article must have been submitted by 5 PM daily or by noon on Saturday for Sunday's publication. A series of stars found in the newspapers' upper right corner indicated the inclusion of black news, meaning it was to be delivered solely to black customers.

.....

Sign Committee Report:

Montgomery HPC Sign Application Report

Property address: 2095 South Hull Street (pre 1951 1621 a& b; 2091 & 2095)

Historic District: Garden District



Construction date: 1930

Roof: Side gable with two smaller front gable projections

Porch: Recessed under main roof slope

Entry steps and handrails: Steps appear to be original, handrails added but unobtrusive

Doors: Entry door on the left is a round top 9 lite door, door on right is 9 lite rectangular door with 3 lite transom. Both original to the structure

Windows: 6:6 and 4:4 wood windows

Shutters & Awnings: N/A

Siding: Brick veneer with stucco in some gables

Foundation: There is a visible soldier course of brick just below the finished floor level, it appears to be a conventional foundation

Burglar Bars: N/A

Front yard fence: N/A

Driveway/parking: This is at the corner of E. Fairview and S. Hull. There isn't space for a traditional driveway on the front and no on-street parking is available.

Other notes: Property used to be a duplex situated on a larger piece of property. A nice example of

Montgomery's version of understated Tudor revival houses and duplexes, featuring the round top door under a sloped roof on the north end, a recessed porch and stone coping around the door on the south end of the west façade. Brick veneer is typical of the style, and it remains unpainted as the builders originally intended to mimic brick Tudor and Jacobean architecture. Wood louvered gable vents, tall chimney with decorative top.

Modifications: Only visible modifications are storm windows and a rear deck.

City Directory & Address Card Information:

- 1935: Dr. Walton HY & Teddy E Smith, assistant state epidemiologist State Board of Health; 2nd unit Eric L & Reddie Darsey, manufacturers agent, self employed 310 Montgomery St (Shepherd Building, demolished) room 607
- 1940: 1621a, John & Kathleen Hughes, salesman Capitol Broadcasting (2nd mezzanine, Exchange Hotel)
- 1945: apt 1 Douglass C. Pritchett, personnel officer US Selective Service; apt 2 Dwight M & Lucille S Beeson, asst occupational officer US Selective Service
- 1950: Harry & Virginia (Ala Serum) Snow, market specialist Alabama Dept of Ag & Industries; Eugene & Anne Ray, salesman Rush Stallings
- 1951: a. Mr. & Mrs Harry Snow
- 1955: George Few; Richard E & Edra E Russell, USAF
- 1960: Mrs. Jane Rushin, teller People's Bank & Trust; Mrs. Veril Spradley (widow Ferrell) annual dept Paragon Press.
- 1964, variance denied to run a beauty shop out of the duplex.
- 1965: 2091 vacant; Mrs. Minnie A Watts, widow Marion, retired

Submitted historical information: None.

Additional photos:



175

1953 Sanborn map





Montgomery HPC Sign Application Report

Property address: 2321 West Cloverdale Park

Historic District: Cloverdale *name requested "Tankersley House 1956"



Construction date: 1956

Roof: Hip with architectural shingles, flat top, rear gable extension

Porch: Recessed

Entry steps and handrails: Likely brick (covered in fig vine) with metal handrail, typical of the age of the house

Doors: Solid wood door flanked by two door sized sidelights

Windows: 9:9 wood on front, 6:6 on side

Shutters & Awnings: Shutters on front original to house

Siding: Brick veneer

Foundation: Unknown

Burglar Bars: N/A

Front yard fence: N/A

Driveway/parking: behind house off of side street, rear access to carport.

Other notes: Stylistically the house combines elements of the emerging ranch style (one story, rare hipped roof) but takes its fenestration and details cues from Colonial Revival (shutters, solid door, symmetrical façade, 9:9 windows). The house is nicely situated on a slight rise at the north end of

Cloverdale Park. House has original hipped roof, a large symmetrically placed chimney, original floor to ceiling windows in front rooms, original shutters, brick surround on outdoor courtyard with lattice design.

Modifications: Addition of covered den, laundry room at back of house. Carport added years ago, sliding glass doors on back. Alterations are visible only because the lot is oddly configured, not visible from front street view.

City Directory & Address Card Information:

- 1960: Mrs. Clementina MacPherson (widow Frank); Mrs. Corrie Tankersley (widow Felix)
- 1965: Mrs. Corrie Tankersley (widow Felix)

Submitted historical information: The house purportedly has 3-4 owners in its 65 year history, with the Tankersley family being the main family in the home.

Additional photos:







1953 Sanborn map



Plaques inside St. John's Episcopal Church