

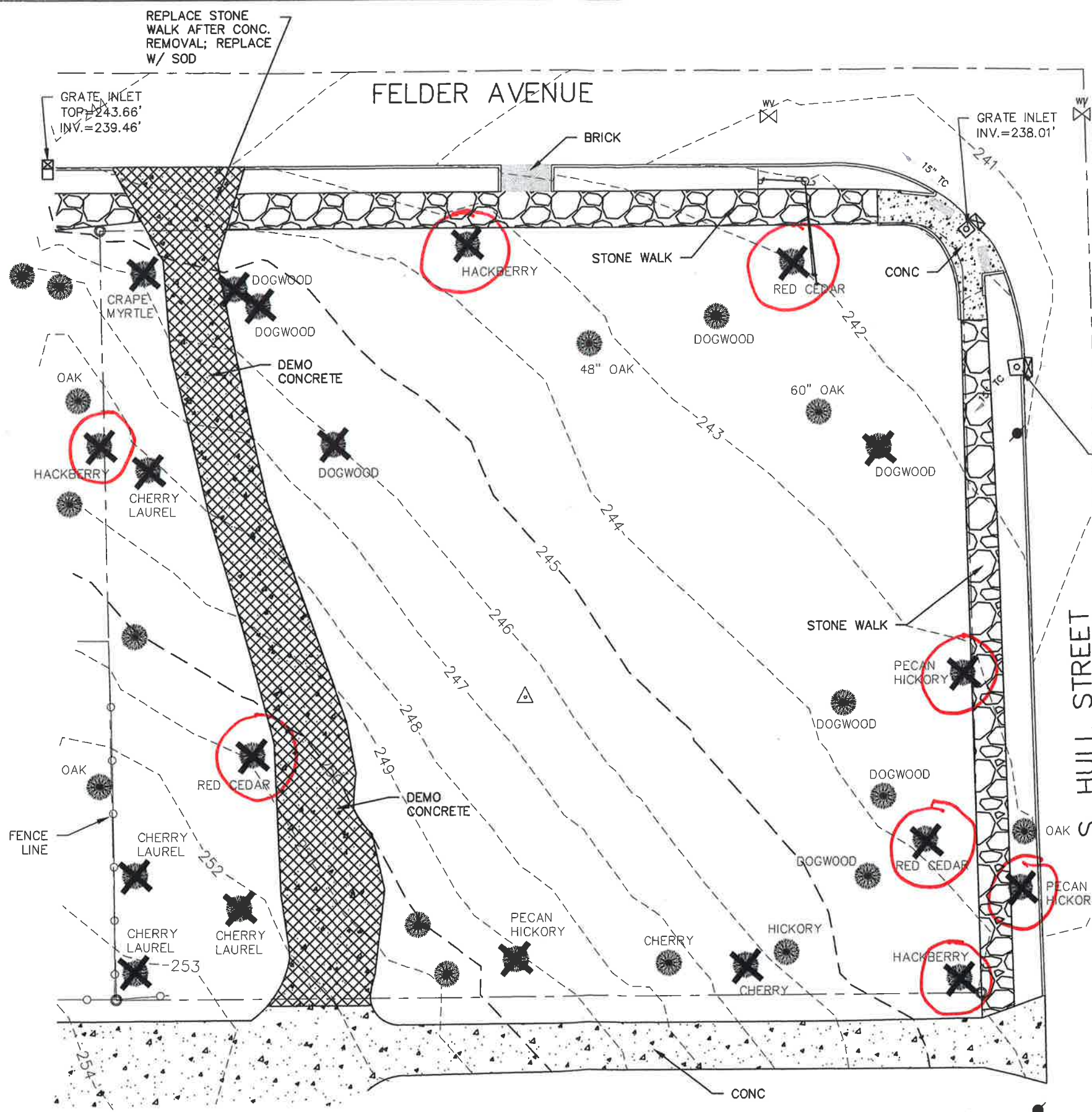



SCALE: 1"=20'

- = GUY POLE
- = WATER VALVE
- = POWER POLE
- = STOP SIGN
- = TREE
- = FOUND IRON PIN



REPLACE STONE WALK AFTER CONC. REMOVAL; REPLACE W/ SOD

GRATE INLET  
TOP=243.66'  
INV.=239.46'

GRATE INLET  
INV.=238.01'

CURB INLET  
TOP=241.50'  
INV. 15"=236.59'  
INV. 24"=236.41'

CURB INLET  
TOP=241.52'  
INV.=237.13'

- TREES TO BE REMOVED
- HACKBERRY
  - RED CEDAR
  - PECAN HICKORY
  - RED CEDAR
  - PECAN HICKORY
  - HACKBERRY
  - RED CEDAR
  - HACKBERRY

- OTHER SMALLER TREES UNDER 12"
- DOGWOOD (DEAD)
  - CHERRY (DEAD)
  - CHERRY LAUREL
  - CHERRY LAUREL
  - DOGWOOD (DEAD)
  - DOGWOOD (DEAD)
  - CRAPE MYRTLE

PROPOSED TREE PLANTING  
SEE LANDSCAPE PLAN



2660 East Chase Lane, Suite 200  
Montgomery, AL 36117  
T 334.271.3200  
GMCNETWORK.COM

Topographic survey  
GMC # GMC PROJECT #  
2/28/19  
DRAWN BY: JB

Trinity Presbyterian Church  
Topographic Survey &  
Demolition & Tree Removal Plan

L1.0



SCALE: 1"=20'

- = GUY POLE
- = WATER VALVE
- = POWER POLE
- = STOP SIGN
- = TREE
- = FOUND IRON PIN

REPLACE STONE WALK & GRANITE CURB AFTER CONC. REMOVAL; REPLACE W/ SOD

GRATE INLET  
TOP=243.66'  
INV.=239.46'

FELDER AVENUE

BRICK

GRATE INLET  
INV.=238.01'

STONE WALK

CONC

48" OAK

DOGWOOD

60" OAK

15" TC

CURB INLET  
TOP=241.52'  
INV.=237.13'

CURB INLET  
TOP=241.50'  
INV. 15"=236.59'  
INV. 24"=236.41'

FENCE LINE

STONE WALK

S. HULL STREET

DOGWOOD

DOGWOOD

DOGWOOD

OAK

CHERRY

HICKORY

CONC

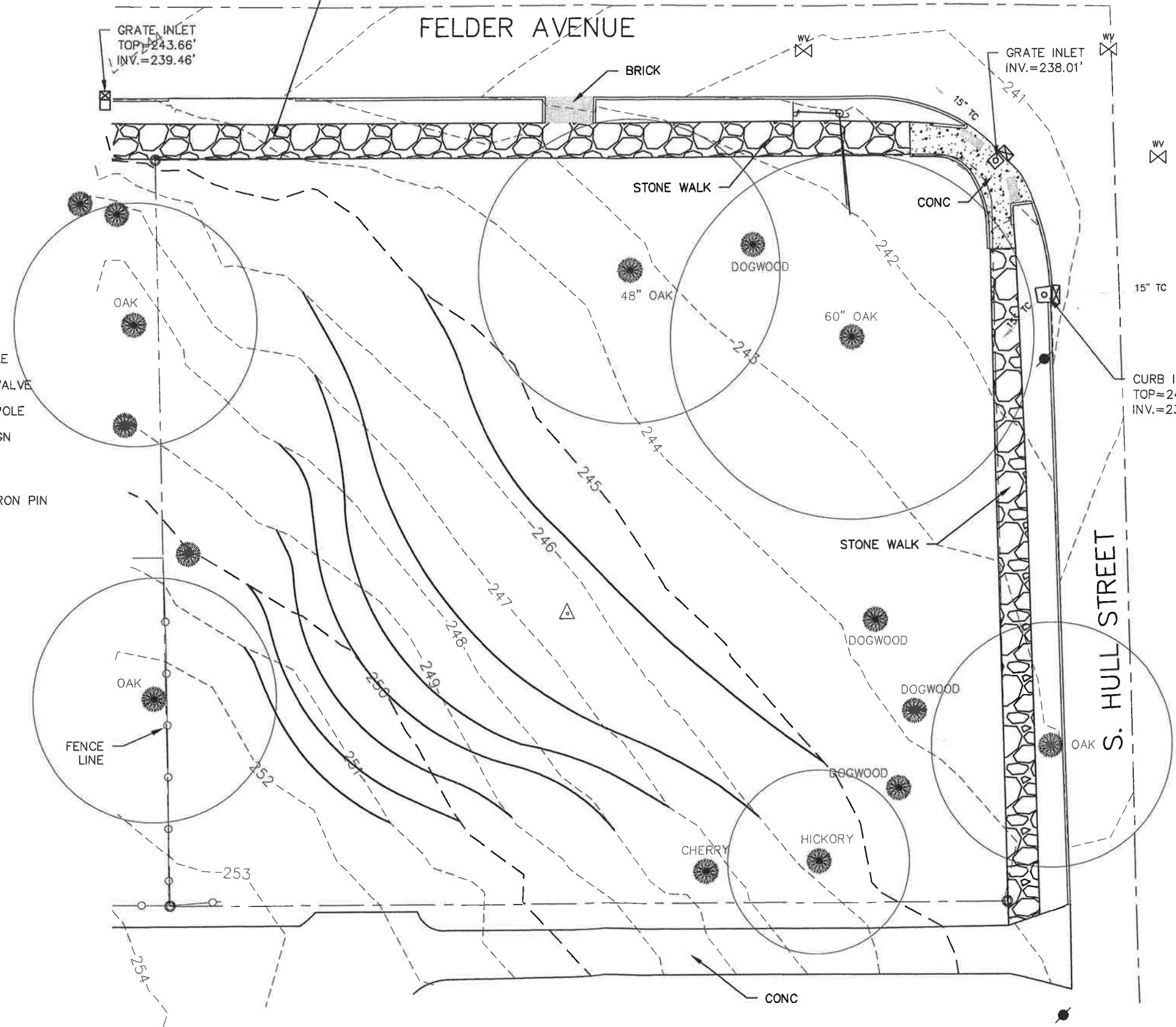

2660 East Chase Lane, Suite 200  
 Montgomery, AL 36117  
 T 334.271.3200  
 GMCNETWORK.COM

Grading Plan  
 GMC # GMC PROJECT #  
 2/28/19  
 DRAWN BY: JB

Trinity Presbyterian Church  
 Grading Plan

L1.1

